

The Flower

This pattern is one of Kathleen Dustin's. It is a stylized daisy, but almost any flower could be created using this technique. Flowers are good subjects. They have radial symmetry and learning to create them will improve your ability to visualize the making of more complex structures.

Start out by constructing the pieces that will be the petals. For this flower, the petals will have several layers of color. Roll a core snake. Next, prepare a larger log of color to do an asymmetrical wrap. Use your brayer to partially flatten the log, leaving it fairly thick. Pinch the edges so they taper and wrap it around your core, roll together. Prepare two more colors to make shading on the edges of the petals. Flatten them a little more than before and use a sheet that covers about half of the cane. Roll these in as well. Next, prepare a jellyroll cane for the center of the flower. Reduce your petal cane so that you can cut five equal pieces to go around the center. Choose a background color that will contrast with the flower and make some triangular wedges. These will separate and shape the petals. If you do not add them, the petals will fuse together.

For certain flower designs this might be desirable. Assemble the cane and roll it together. The top edges of the petals will still be showing. A final wrap in the background color will finish the pattern. As before, the flower cane can be reduced. In the photo, I have put small slices onto a base bead of the same color. The flowers appear to be floating on the finished bead.

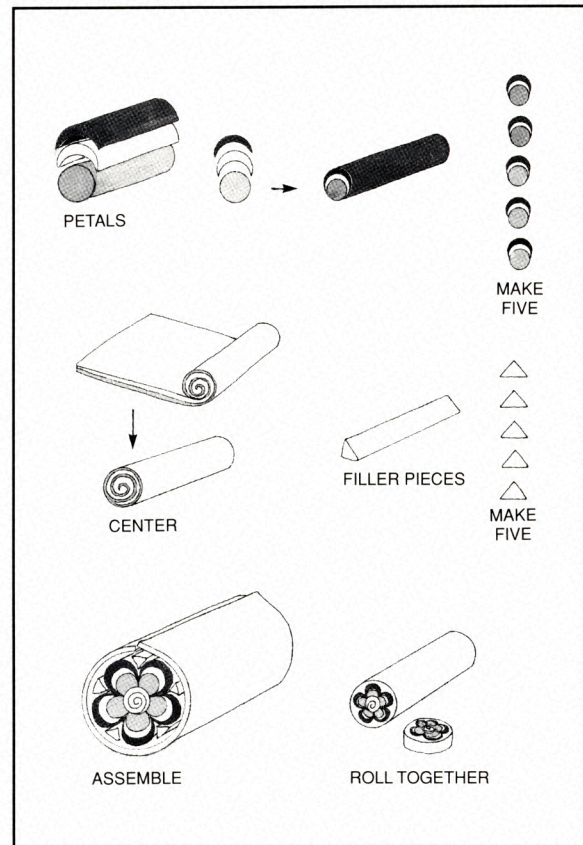

Illustration 52. The Flower.



55. A Flower Cane. The steps in the process of making a flower cane are shown using Sculpey III. The flower pattern is one of Kathleen Dustin's designs.